

HPB TECHNOLOGY CO., LTD.

# *Self-Priming Engine Pump Sets*



[www.hpb-tech.tw](http://www.hpb-tech.tw)

# Self-Priming Engine Pump Sets



## Profile

The pump is started by diesel engine that drives this pump directly. The pump equipped non clog impeller and vacuum pump. While impeller is rotating and vacuum pumps synchronized, that drive out air and finished self priming water. Therefore, this pump can drain off water effectively.



## Features

1. Self-Priming pumps have a special design vacuum that can detect water automatically, under no water condition.
2. The special design tank can separate water and air. The pump will fill water in few minutes automatically.
3. Non-clog design impeller, can through large solid. The pump has clean hole for cleaning sediment.
4. Engine RPM adjustment tool, allow you control the rotational speed from 1200 ~ 1800RPM.
5. Advanced control system for warning and protection.
6. The better aluminum-made quick connection joint is easy to operate and light weight. The rubber water pipe can match the connecting joint firmly and closely.
7. Light weight and small size, easy to setup and moveable. This pump is available for draining water at basement.

## Applications

- |  |   |
|--|---|
| <ol style="list-style-type: none"> <li>1. The groundwater control or de-water from lowlands.</li> <li>2. The sewage water drainage.</li> <li>3. Flood waters drainage promptly.</li> </ol> | <ol style="list-style-type: none"> <li>4. Drains off water for ships.</li> <li>5. Drain off water in the remote suburb.</li> <li>6. Water control for aqua farm.</li> <li>7. Draining water at basement in building.</li> </ol> |
|--|---|



## Performance Curve

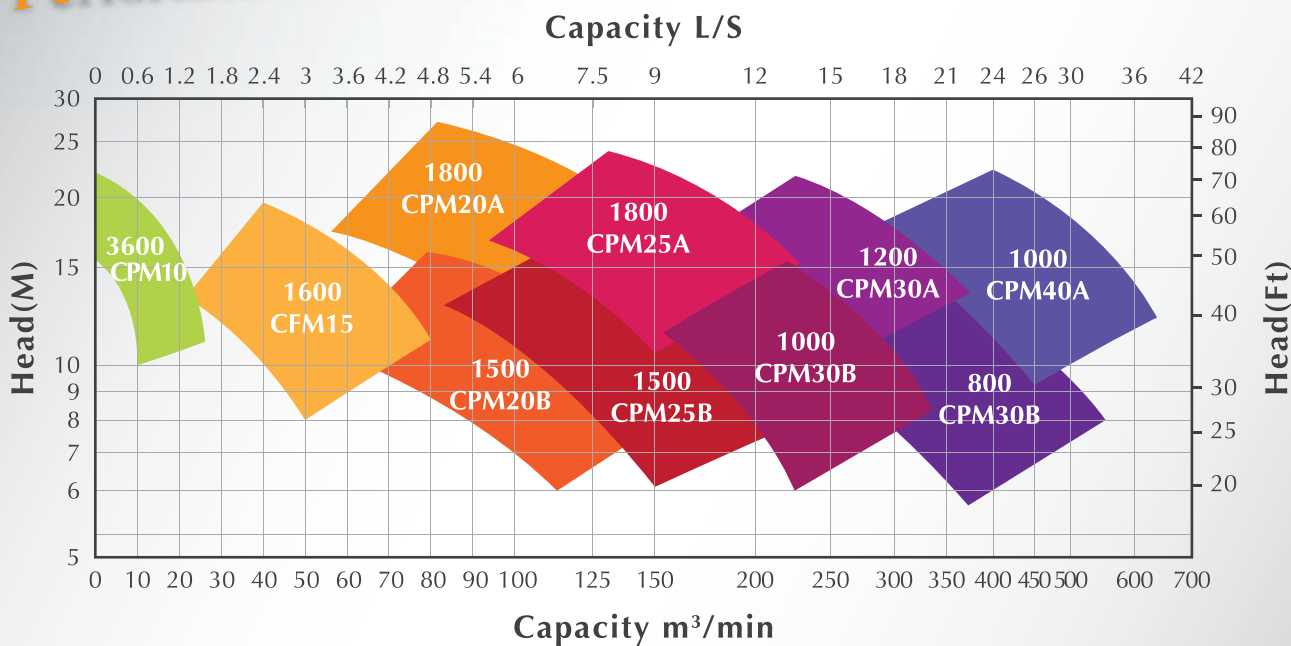

## Products

| Model  | Diameter (inch) | Max. Capacity (m³/min) | Max. Head (m) | Speed (rpm) | Solid Passage (mm) | Air Displacement (l/mm) |
|--------|-----------------|------------------------|---------------|-------------|--------------------|-------------------------|
| CPM10  | 4               | 1.5                    | 24            | 3600        | 20                 | -                       |
| CPM15  | 6               | 5                      | 22            | 1600        | 40                 | 300                     |
| CPM20A | 8               | 12                     | 27            | 1800        | 40                 | 700                     |
| CPM20B | 8               | 11                     | 16            | 1500        | 40                 | 700                     |
| CPM25A | 10              | 15                     | 24            | 1800        | 60                 | 700                     |
| CPM25B | 10              | 16                     | 18            | 1500        | 75                 | 700                     |
| CPM30A | 12              | 24                     | 25            | 1200        | 65                 | 800                     |
| CPM30B | 12              | 21                     | 20            | 1000        | 75                 | 800                     |
| CPM40A | 16              | 41                     | 25            | 900         | 85                 | 1000                    |
| CPM40B | 16              | 36                     | 16            | 600         | 100                | 1000                    |

Customer's specifications are acceptable.

# Structure Drawing

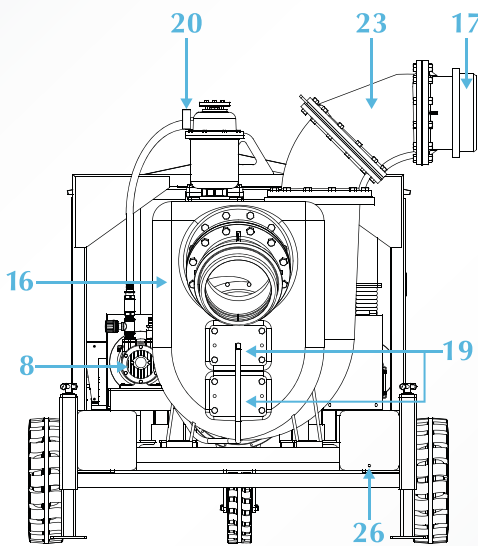
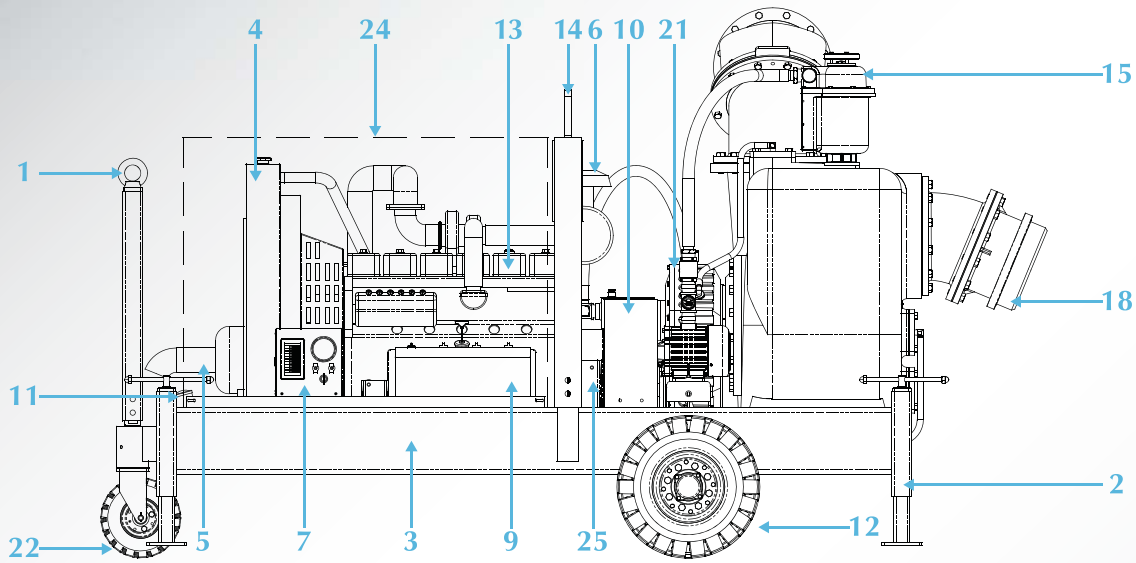

- |                    |                       |
|--------------------|-----------------------|
| 1. Drag rod        | 14. Lift rack         |
| 2. Adjustable rack | 15. Vacuum chamber    |
| 3. Fuel tank       | 16. Self prime pump   |
| 4. Radiator        | 17. Outlet            |
| 5. Exhaust pipe    | 18. Inlet             |
| 6. Air cleaner     | 19. Cleaning hole     |
| 7. Control panel   | 20. Vacuum gauge      |
| 8. Vacuum pump     | 21. Gear box          |
| 9. Battery         | 22. Steering wheel    |
| 10. Coupling       | 23. Check valve       |
| 11. Fuelling hole  | 24. Protective shield |
| 12. Rubber wheel   | 25. Lube tank         |
| 13. Engine         | 26. Leak plug         |

# Main Accessories

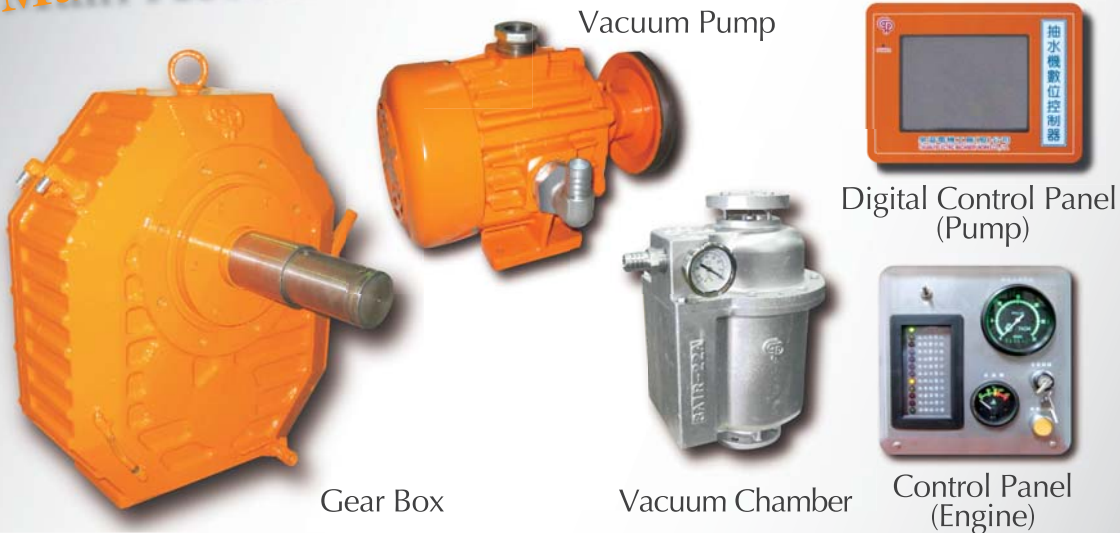

Steel Wire Reinforced Rubber Hose

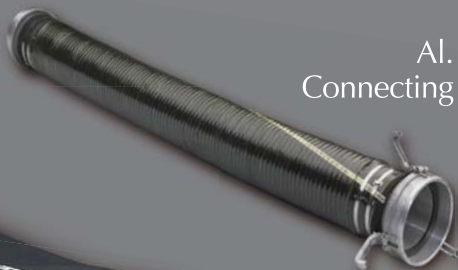

Al. Quick Connecting Elbow



Water Supply Rubber Hose



Al. Quick Connecting Joint



Stainless Strainer

## Specification

### Water Supply Rubber Hose

| Item | Diameter |      | Thickness |      | Weight |       | Working Pressure | Maximum Pressure |
|------|----------|------|-----------|------|--------|-------|------------------|------------------|
|      | mm       | inch | mm        | inch | kg/m   | lb/ft |                  |                  |
| 1    | 100      | 4    | 2.3       | 0.09 | 2.0    | 0.9   | 3                | 6                |
| 2    | 150      | 6    | 3         | 0.12 | 3.6    | 2.4   | 3                | 6                |
| 3    | 200      | 8    | 4         | 0.16 | 5.0    | 3.4   | 3                | 6                |
| 4    | 250      | 10   | 5         | 0.20 | 6.0    | 4.0   | 3                | 6                |
| 5    | 300      | 12   | 6         | 0.24 | 8.0    | 5.3   | 3                | 6                |
| 6    | 400      | 16   | 8         | 0.32 | 12     | 8.1   | 3                | 6                |

### Steel Wire Reinforced Rubber Hose

| Item | Diameter |      | Thickness |      | Length | Weight |      | Bending Radius |       | Working Pressure | Maximum Pressure |
|------|----------|------|-----------|------|--------|--------|------|----------------|-------|------------------|------------------|
|      | mm       | inch | mm        | inch |        | m      | kg/m | lb/ft          | mm    |                  |                  |
| 1    | 100      | 4    | 6         | 0.24 | 1~15   | 4      | 2.7  | 600            | 23.6  | 5                | 10               |
| 2    | 150      | 6    | 7         | 0.28 | 1~15   | 7      | 4.7  | 900            | 35.4  | 5                | 10               |
| 3    | 200      | 8    | 8         | 0.31 | 1~15   | 10     | 6.7  | 1200           | 47.2  | 5                | 10               |
| 4    | 250      | 10   | 9         | 0.35 | 1~12   | 15     | 10.1 | 1500           | 59.1  | 5                | 10               |
| 5    | 300      | 12   | 10        | 0.39 | 1~12   | 18     | 14.8 | 1800           | 70.9  | 5                | 10               |
| 6    | 400      | 16   | 14        | 0.55 | 1~10   | 42     | 28.3 | 3000           | 118.1 | 5                | 10               |



宙峰有限公司  
HPB TECHNOLOGY CO., LTD.

12F, No. 254, Sec. 5, Chung Hsiao E. Rd., Taipei City 110, Taiwan  
Tel : +886-2-2720-1366 Fax : +886-2-2720-3883  
Email : hpb.tech@msa.hinet.net Website : www.hpb-tech.tw